

Genuine Accessories



Vehicle Model Elantra
 Model Year 2011~
 Part No. 3X023 ADU01











Accessory Sunroof Wind Deflector
 Difficulty (B)

- Accessory Installation





Note: Difficulty stated above reflects the minimum level of expertise required to install the accessory.

(A) Customer (B) Dealer Technician (C) Master Technician

Instructional Symbols / Definitions

	Denotes warnings that may lead to serious physical injury or vehicle damage.		Denotes quality processes to be checked prior to moving to the next step.	Denotes safety equipment required to be used such as a mask, goggles, rubber gloves, and hearing protection.	
	Denotes cautions to be taken to avoid physical injury or electronic component damage.		Denotes specific tools that are necessary to complete the step.		
	Denotes cautions to be taken to avoid vehicle and component damage.		Denotes instructional steps necessary to complete the process.		
				Mask	Goggles
				Rubber Gloves	Hearing Protection

Basic Required Hand Tools

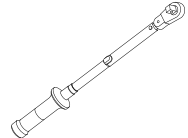
					
Soap & Water	Lint Free Cloth	#2 Phillips Screwdriver	Non-Permanent Marker or Pencil	#2 Phillips Socket	Torque Wrench



50/50 Isopropyl Alcohol (70%) & Water

FMVSS 110 Compliance Information

Part Number: 3X023 ADU02

1.9 lbs
 0.86 kg
 (Gross Weight)

All dealers must determine if the weight they have added in the form of all options or accessories, when added to the weight of all Port/Dealer Installed options or accessories, exceeds the lesser of 1.5% of GVWR or 100 lbs. If the additional weight does exceed the lesser of the indicated thresholds, a "Load Carrying Capacity Reduced" label must be installed. A black, fine-point, indelible marker must be used to write by hand onto the label, the reduced carrying capacity in kilograms or pounds, which is the total weight of all added options and accessories. Load Label Part Number:

NP070 - 09003

Notes to the Installer:

- 1) Read the entire installation instruction prior to beginning the installation of this accessory.
- 2) Combine a mixture of 50/50 Isopropyl Alcohol (70%) and water into a spray bottle.
- 3) Adhesives used in this product are sensitive to temperature during installation, only install this product to the vehicle if the temperature is between 60° - 80°F \ 15° - 27°C. Installing the parts to the vehicle outside of this temperature may lead to a reduced level of performance.
- 4) Installation of all parts should not occur in direct sunlight or if the vehicle has been parked in direct sunlight and is hot as a result. Both the parts and the vehicle should be at the same temperature 60° - 80°F \ 15° - 27°C during the installation to ensure maximum adhesion.
- 5) Make sure the vehicle is completely clean before the accessory is installed.
- 6) Ensure the vehicle is properly protected in the area(s) that the accessory is to be installed.
- 7) To prevent vehicle damage, never place tools on top of painted surfaces, seats, dash pad, console or floor carpets/mats.
- 8) Always wear appropriate safety gear to include gloves and safety glasses when required.
- 9) Use of Sunroof Wind Deflector may result in some wind noise heard.
- 10) Do not wash the vehicle for 48 hours after installation.
- 11) Do not drive the vehicle for 1 hour after installation.



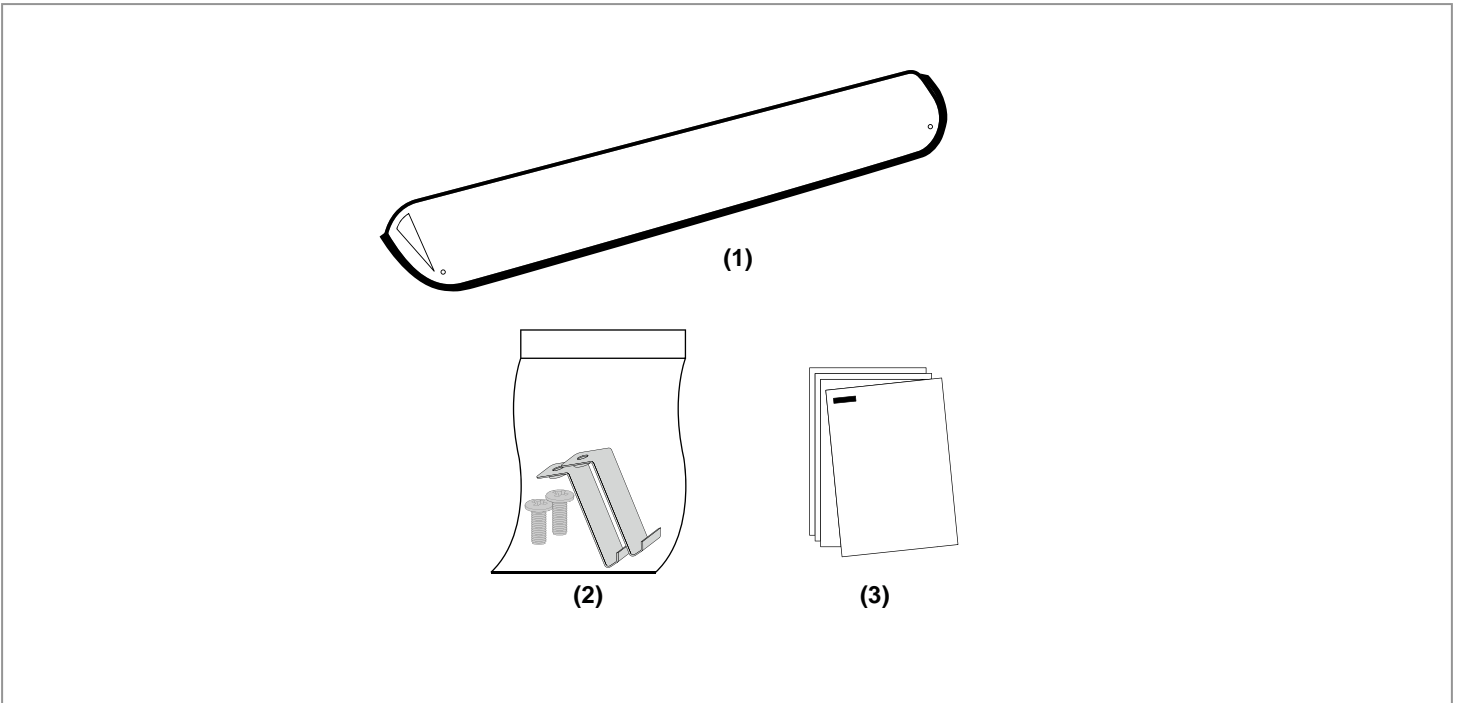

Genuine Accessories

Kit Overview:

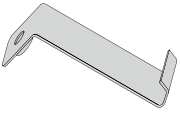

No.	Qty.	Description
1	1	SUNROOF WIND DEFLECTOR
2	1	HARDWARE KIT
3	1	INSTALLATION INSTRUCTION

Hardware Overview:

A		B		C		D	
2	Metal Clip	2	Screw	2	Washer	2	Abrasive Resistant Tape

Hardware Total
8

Genuine Accessories

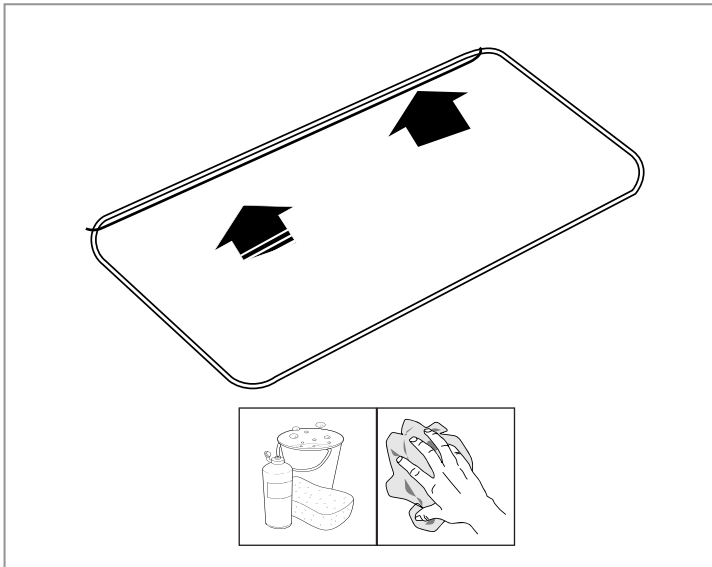

	Soap & Water and Clean Cloth	1
NOTE	<ol style="list-style-type: none"> 1. Thoroughly clean the roof and surrounding areas. 2. Wipe away any residue and allow to completely dry. 3. Open the sunroof. 	
	Make sure all surfaces are completely dry before trial fitting the Sunroof Wind Deflector.	

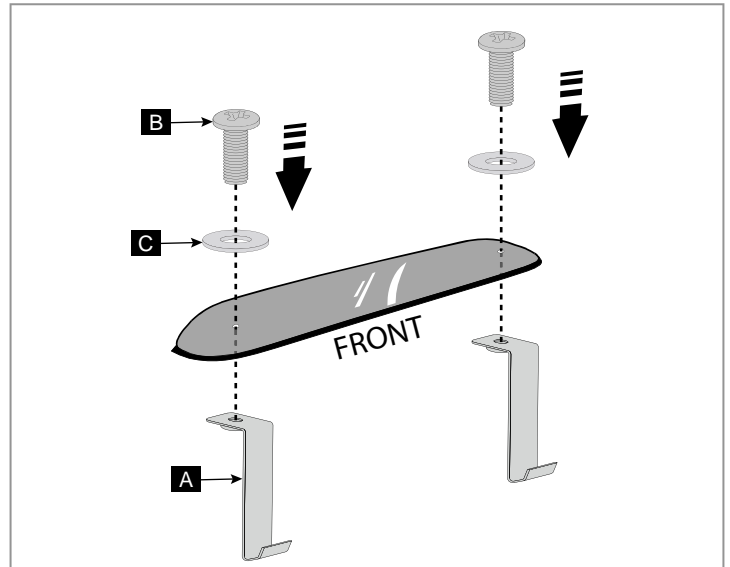

	#2 Phillips Screwdriver	2
NOTE	<ol style="list-style-type: none"> 1. Loosely thread the Sunroof Wind Deflector to the two (2) metal clips "A" using the two (2) screws "B" and two (2) washers "C" as shown. 	
	Do not over tighten.	

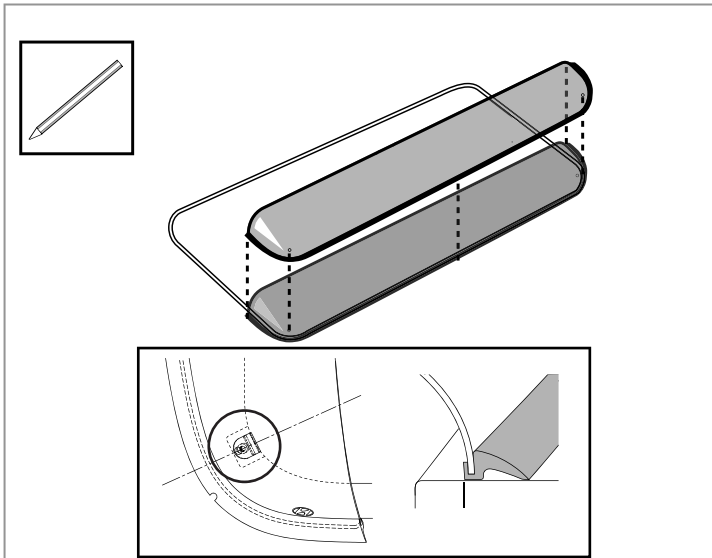

	Non-Permanent Marker or Pencil	3
NOTE	<ol style="list-style-type: none"> 1. Trial fit the Sunroof Wind Deflector centrally on the sunroof opening. <ul style="list-style-type: none"> - Confirm that the area between the edge of the roof and the Sunroof Wind Deflector is equal on both sides. 2. Using a non-permanent marker or pencil, mark the locations of the clips on the edge of the sunroof opening. 3. Remove the Sunroof Wind Deflector. 	
		

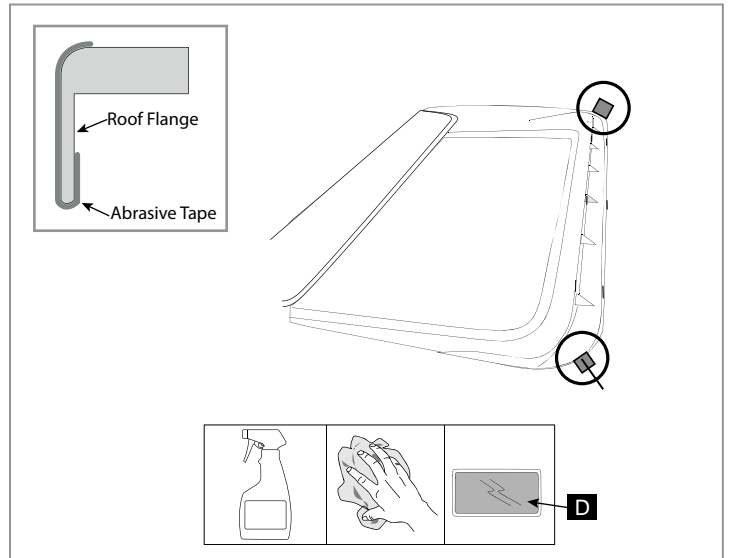

	50/50 Isopropyl Alcohol (70%) & Water and Clean Cloth	4
NOTE	<ol style="list-style-type: none"> 1. Clean the topside and underside of the roof flange at the previously marked locations with the 50/50 isopropyl alcohol (70%) & water. 2. Remove any remaining residue or moisture with a dry clean cloth. 3. Apply the two (2) abrasive resistant tapes "D" to the cleaned areas, ensuring the tape is wrapped around and underneath the roof flange as shown. 	
	Ensure tape wraps around the roof flange.	

Genuine Accessories

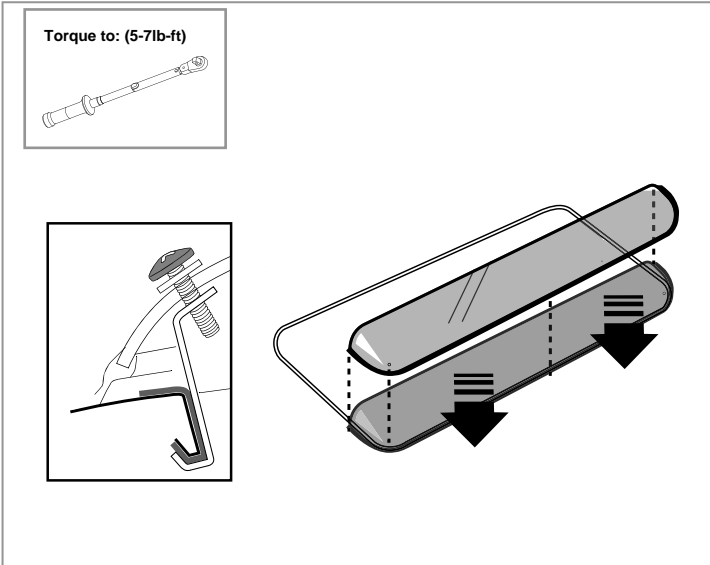



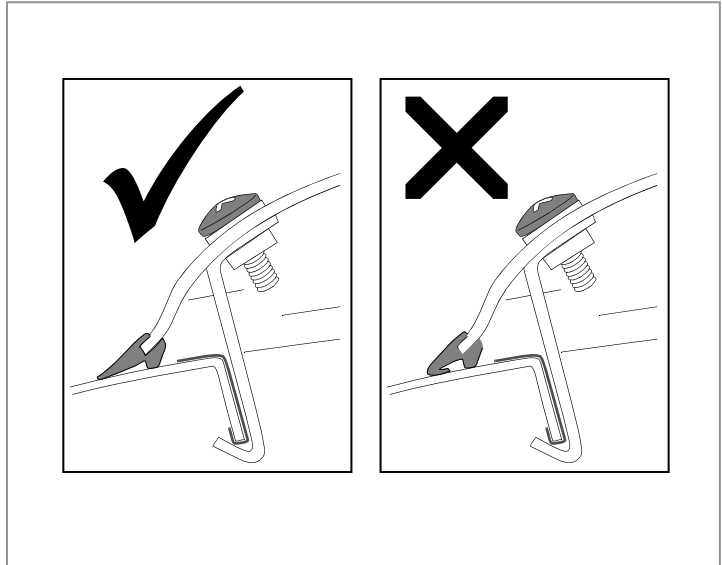

🔑	Torque Wrench, #2 Phillips Socket	5
N O T E	<ol style="list-style-type: none"> 1. Hold inner vehicle deflector down by hand to aid installation process. 2. Fit the Sunroof Deflector centrally onto roof. Ensure the rubber gasket is flat against the roof and is not curling under itself. <ul style="list-style-type: none"> - Confirm that the area between the edge of the roof and the Sunroof Wind Deflector is equal on both sides. 3. Ensure the clips are positioned over the abrasive resistant tape. 4. Fully tighten the two (2) Screws "A". Torque to: 5-7 lbf-in 	
✔	<ul style="list-style-type: none"> - Use torque specifications when securing Screws to prevent movement of Sunroof Wind Deflector. - Ensure Clips are positioned over Tape preventing direct contact to the paint. Failure to do so may result in paint damage. 	



🔑		6
N O T E	<ol style="list-style-type: none"> 1. Make sure gasket is flat against roof, if it is curled under, loosen screws on Sunroof Wind Deflector and adjust the gasket as necessary while following the installation notes in step 5. 	
✔		

Genuine Accessories

Visual Check

Items To Be Checked	Results of the Check
 Make sure the Clips are installed over the Abrasive Resistant Tapes (Step 5).	The Clips are correctly installed.
 Check the position of the Sunroof Wind Deflector to make sure that it is positioned centrally (Step 5).	The Sunroof Wind Deflector is positioned centrally, with the areas between the edge of the roof and the Sunroof Wind Deflector equal on both sides.
 Fully tighten the Screws to torque specifications (Step 5).	The Screws are correctly installed.
 Check rubber gasket is flat against the roof. (Step 5&6).	The Screws are correctly installed.

Genuine Accessories Cleaning Instructions

**Spray with a firm water spray to remove any loose dirt, then wash with water, detergent and a soft cloth or sponge.
DO NOT use petroleum based solvents or abrasives.**

Retain these instructions in your glovebox for future reference.